



PRODUCT CATALOGUE

Sheet metal & construction sealants • HVAC sealants • Caulking guns
Steel roof paint • Painting Tools • Duct profile systems • Tools for duct profile systems



Table of contents

Sheet metal & construction sealants	4
Accessories for sheet metal & construction sealants	12
HVAC sealants	14
Accessories for HVAC	21
Caulking guns & accessories	22
Steel roof paint & related products	26
Painting tools	38
Duct profile systems	48
Tools & accessories for duct profile systems	58

SHEET METAL & CONSTRUCTION SEALANTS





Sheet metal & construction sealants

ABRA products are developed in Sweden to withstand tough conditions, wherever in the world professional sheet metal work is performed.

With a climate of red-hot summer to indescribable cold, we have a long gained experience and we have been able to test our products in the best way possible. Feedback from Swedish tinsmiths has been very important for the quality of today's products, which are constantly conquering new markets.

FAQ

- **Can you use Runotex Tix Transparent with plastic windows?**
No.
- **How many linear metres of seam will a standard M82 cartridge seal?**
Approximately 25 linear metres with a diameter of 4 mm.
- **Can you glue stainless steel with Seal & Fix or High Tack & Fix?**
Yes.



Lap Sealing Oil M80

Seam sealant for all types of metal roof with a slope exceeding 11.3°.

- Expands on contact with water
- Eco-friendly
- Non-drying
- Brush-on or dip
- Solvent-free
- Low-odour
- 1 l is sufficient for approx. 100 linear metres
- Application temperature: -10 to +70 °C

Recommended accessories:

Seaming oil brush for 1 litre seaming oil bottle

Special brush that fits onto the 1 litre bottle of seaming oil. The XL seam brush is a larger seaming oil brush suitable for the bottle. It is more durable, with premium-quality bristles for a longer life.

400000	Lap Sealing Oil M80	5 l can
400001	Lap Sealing Oil M80	12 x 1,0 l
<i>Recommended accessories</i>		
200285	Seam brush for 1 litre lap seaming oil bottle	Sold individually
200287	XL seam brush for 1 litre lap seaming oil bottle	Sold individually



M82

Butyl-rubber-based seam sealant for all types of metal roof, which remains tacky in the seam for a durable seal.

- Seam sealant for all metal roofs with seams
- 0.3 litre cartridge is sufficient for approx. 25 linear metres with a 4 mm diameter seam
- Frost resistant
- UV resistant
- Removeable
- Boiling point 150-200 °C
- Flash point 290 °C
- Application temperature: -20 to +70 °C

Recommended accessories:

Seam applicator M300/M600 (see page 25)

400050	M82	Blue	12 x 0,3 l
400051	M82	Transparent	12 x 0,3 l
400055	M82 sausage	Blue	12 x 0,6 l



Runotex Tix Transparent

All-round sealant based on butyl rubber.

- Seam sealant for all metal roofs with seams
- Suitable for sealing around windows and guttering
- 0.3 litre cartridge is sufficient for approx. 25 linear metres with a 4 mm diameter seam
- Frost resistant
- UV resistant
- Removeable
- Boiling point 150–200 °C
- Flash point 290 °C
- Application temperature: -20 to +70 °C

Recommended accessories:

Seam applicator M300/M600 (see page 25)

400100	Runotex Tix Transparent	Transparent	12 x 0,3 l
400102	Runotex Tix Transparent	Transparent	12 x 0,1 l



Smart Wipes / Hand Wipes

Smart wipes:

A strong cleaning cloth for effective removal of joint sealant and paint.

Hand wipes:

Wet wipes for removing dirt, grease and oils. Easy to clean hands, tools and car interior.

400785	Smart Wipes	50 pcs/bag
400790	Hand Wipes	50 pcs/bag



Prep Wipes

Cleaning cloths of non-woven, melt-blown polypropylene fabric. Ideal for cleaning work surfaces, tools and components. The cleaning cloth does not release lint or any absorbed residue. The wipes are not intended for cleaning hands.

- Removes excess seam sealant
- Can be used to clean surfaces before and after caulking/painting
- Removes dry spray

400780	Prep Wipes	100 pcs/bag
--------	------------	-------------



Steel Profile Sealer (SPS)

Butyl-rubber-based sealant for sealing overlapping TRP plate.

- Excellent adhesion to all metal sheeting
- Frost resistant
- Good adhesion
- Suitable for use in all weathers
- Quick application
- Withstands 100 °C after drying
- Application temperature: -20 to +70 °C

400060	Steel Profile Sealer	Grey	12 x 0,3 l
--------	----------------------	------	------------



Seal & Fix

Elastic MS-polymer-based sealant for bonding and sealing. Adheres to most types of factory-painted sheet metal. Excellent for HB polyester, Green Coat, Hard Coat, plastisol, aluminium, copper, zinc, roof tiles, wood, concrete, glass etc. Bonding surfaces must be clean, dry and free from grease and dust. Pigmented product provides the best adhesion.

- Insignificant shrinkage
- Skin formation after 10 min
- Curing/day 2-3 mm
- Solvent-free
- Can be painted over with most types of paint
- UV resistant
- Frost resistant
- Application temperature: +5 to +50 °C
- Working temperature: -40 to +100 °C

Item no.		Colour	RAL	NCS (nearest)	
400167	Seal & Fix	Transparent			12 x 0,29 l
400168	Seal & Fix BOND	Black	9005	S 9000-N	12 x 0,29 l
400169	Seal & Fix BOND	Grey	7030	S 4502-Y	12 x 0,29 l
400170	Seal & Fix	Silver	9006		12 x 0,29 l
400171	Seal & Fix	Dark silver	9007		12 x 0,29 l
400177	Seal & Fix BOND	Red	8012	S 6030-Y80R	12 x 0,29 l
400178	Seal & Fix BOND	White	9003	S 0500-N	12 x 0,29 l
400179	Seal & Fix BOND	Brown	8017	S 8005-Y80R	12 x 0,29 l
400181	Seal & Fix BOND	Brick Red	8004	S 4040-Y70R	12 x 0,29 l
400182	Seal & Fix BOND	Dark grey	7015	S 7005-R80B	12 x 0,29 l
400183	Seal & Fix BOND	Light Grey	9016	S 1005-R80B	12 x 0,29 l



High Tack & Fix

Professional installation adhesive with rapid adhesion. Bonds most construction materials.

- Quick bonding
- High grip
- Weather resistant
- Insignificant shrinkage
- Application temperature: +5 to +40 °C
- Working temperature: -40 to +100 °C

400410	High Tack & Fix	White	12 x 0,29 l
--------	-----------------	-------	-------------



K500 Construction Adhesive

A physically drying single-component adhesive. Adheres to most building materials, including plastic, sheet metal, wood, tile, stone and brick.

- Frost resistant
- Contact adhesive
- Fills seams
- Adheres to damp, cold and oily surfaces

400400	K500 Construction Adhesive	Yellow beige	12 x 0,3 l
--------	----------------------------	--------------	------------



Aquaseal

Repair compound and sealant that adheres to most surfaces, such as aluminium, zinc, lead, glass, copper, stone, asphalt, Eternit, roofing felt, tiles and wood. Not suitable for use with polystyrene sheets and strong solvents.

- Fibre reinforced
- Seals under water
- Frost resistant
- Can be overpainted
- Highly elastic
- Bridges cracks up to 10 mm wide
- UV resistant
- Application temperature: -5 to +40 °C
- Working temperature: -25 to +100 °C

400160	Aquaseal	Grey	NCS S 8000-N	12 x 0,3 l
400165	Aquaseal	Grey	NCS S 8000-N	5,0 l
400156	Aquaseal	Black	NCS S 9000-N	12 x 0,3 l
400157	Aquaseal	Black	NCS S 9000-N	5,0 l
400158	Aquaseal	Transparent		12 x 0,3 l
400159	Aquaseal	Transparent		5,0 l



Allround Silicone

A neutral, highly elastic silicone sealant for sealing inside and out. Adheres to metals, glass, ceramics and PVC.

- Poke-proof
- UV resistant
- Anti-mould treated
- Free from acetic acid
- Skin formation after about 5 min
- Product meets CE standards
- Application temperature: +1 to +30 °C
- Working temperature: -60 to +120 °C
- Bostik Allround Silicone B&S - ISEGA Food-grade

400452	Allround Silicone 2.0 F quick-drying	Transparent		12 x 0,3 l
400161	Bostik Allround Silicone B&S	White		12 x 0,3 l
400162	Bostik Allround Silicone B&S	Grey		12 x 0,3 l
400164	Bostik Allround Silicone B&S	Black		12 x 0,3 l



Sealing foam FM 310

Single-component moisture hardening polyurethane foam for year-round use, with two-in-one valve. For sealing and filling around door and window frames, pipes and apertures etc. Each bottle provides around 46 litres of foam in a gun, and around 35 litres when applied using the nozzle.

- Excellent adhesion to most materials
- Tack-free within 10 minutes
- Can be overpainted
- Noise insulation 60 dB
- Application temperature: -10 to +35 °C
- Working temperature: -40 to +90 °C

400190	Sealing foam FM 310, 750 ml	Green	Sold individually
--------	-----------------------------	-------	-------------------



Isocyanate-free hybrid foam FM 810

Hybrid foam with two-in-one valve for sealing and filling around door and window frames, pipes and apertures etc. Each bottle provides up to 8 litres of finished foam.

- Excellent adhesion to most materials
- Tack-free within 10–20 minutes
- Can be overpainted
- Noise insulation 60 dB
- 100% isocyanate-free
- Application temperature: -10 to +35 °C
- Working temperature: -20 to +90 °C

400195	Isocyanate-free hybrid foam FM 810, 500 ml	White	Sold individually
--------	--------------------------------------------	-------	-------------------



Runotex Sliding clip

Sliding clip with pre-fitted stainless screw. Torx head T20.

510000	Runotex Sliding clip, galvanised	500 pcs/can
--------	----------------------------------	-------------



Runotex Fixed clip

Fixed clip with pre-fitted stainless screw. Torx head T20.

510010	Runotex Fixed clip, galvanised	500 pcs/can
--------	--------------------------------	-------------



Expanding Sealing Strip

Expanding Sealing Strip is an elastic sealing strip for ducts, impregnated with an acrylic-based, UV-stabilised resin. The sealing strip is recommended as an exterior weather seal in the building and construction industry. Areas of use:

- Installing windows
- Façades, including natural stone
- Thermal insulation, timber houses
- Wood, structure, plaster and sheet steel applications
- Prefab applications, noise insulation for walls and ceilings

500985	Expanding Sealing Strip H 3 mm x W 7/15 mm x L 8 m	8 m/piece
500930	Expanding Sealing Strip H 1 mm x W 4/10 mm x L 12 m	12 m/piece
500935	Expanding Sealing Strip H 7 mm x W 12/20 mm x L 8 m	8 m/piece



Bitumen tape

Self-adhesive sealing strip with aluminium film for protection and sealing of metal, plastic, Eternit, roofing, skylights, railings, glass and plastic structures, tiles, gutters, pipes and sheets. Application surfaces must be dry and compact, clean and free from contamination.

- UV resistant
- Adhesion to primed concrete and steel: > 250 N
- Can be overpainted
- Application temperature: +5 to +45 °C
- Working temperature: -40 to +80 °C

400300	Bitumen tape (50 mm x 10 m)	Aluminium	12 x 10 m
--------	-----------------------------	-----------	-----------

Uni-Bevel



The measuring tool that makes it easier to do a precise job. Measure and record angles and dimensions in your workshop, and then you can make the pieces on site. This sliding bevel makes it easier to make fittings. You can transfer angles and adjust details. The accompanying stocks may be useful when working with guttering. Uni-Bevel is perfect for making sloping roofs and façade panels.

520100	Uni-Bevel 2.0 RFR 500 x 250 mm (incl. 2 stocks)	Sold individually
520110	Stock for Uni-Bevel	Sold individually

HVAC SEALANTS





HVAC sealants

The sealants intended for the ventilation industry is manufactured at the production facility in Getinge, Halland.

Sunchem can cater for most needs, from products with high environmental requirements to products that can withstand harsh environments. Local production means great flexibility and short lead times.

FAQ

- **Is there any silicone or surface tension altering material in A95 Vent?**
No.
- **When should B75 Butyl be used?**
B75 Butyl should be used in wet and humid environments, where water-based products are unsuitable. B75 can also be used in sub-zero temperatures.
- **Which sealant is most resistant to oil, grease and solvents?**
Ventseal.
- **Can I leave A95 Vent in a service vehicle in sub-zero temperatures?**
Yes - at least down to -18 °C.



A95 Vent

Acrylic-based sealant for ventilation ducts and penetrations.

- Frost resistant
- Water-based
- Eco-friendly
- Can be overpainted
- Tack-free after 30 min
- Fully cured after 24 h in room temperature
- Reduces noise level in ducts
- Application temperature: +5 to +40 °C
- Working temperature: -40 to +80 °C

400550	A95 Vent	Grey	12 x 0,3 l
400552	A95 Vent	Grey	5 l can



Multiacryl

White acrylic-based caulk and sealant. Ideal for sealing around windows, doors, cornices, skirting, vents and penetrations. Adheres to concrete, wood, plaster, brick, stone, painted surfaces and most metals. Suitable as an interior and acoustic caulk.

- Frost resistant
- Water-based
- Eco-friendly
- Can be overpainted
- Tack-free after 30 min
- Fully cured after 24 h
- Application temperature: +5 to +40 °C
- Working temperature: -40 to +80 °C

400551	Multiacryl	NCS S 0500-N	White	12 x 0,3 l
--------	------------	--------------	-------	------------



B75 Butyl

Butyl-rubber-based sealant for ventilation ducts, fan rooms and penetrations.

- Resistant to water, weak acids and alkalis
- Tack-free after about 12 h
- Can be overpainted
- Reduces noise level in ducts
- Odorless
- Application temperature: -25 to +40 °C
- Working temperature : -25 to +70 °C

400500	B75 Butyl	Grey	12 x 0,3 l
400501	B75 Butyl	Grey	5 l can



Ventseal



Ventseal is an MS polymer-based ventilation sealant with a very wide range of applications. The product is suitable for sealing and gluing ventilation components, rectangular or round ventilation ducts, penetrations and fan rooms etc.

- Flexible
- UV resistant
- Non-shrinking
- Solvent-free
- Glues & seals
- Can be overpainted
- Excellent adhesion to sheet metal material
- Resistant to water, oil, grease etc.
- Working temperature: -40 to +100 °C
- Indoors & outdoors
- Application temperature: +5 to +50 °C

400555	Ventseal	Light Grey	12 x 0,29 l
--------	----------	------------	-------------



Falskitt AA

Non-drying sealant for use when making duct rails for rectangular ventilation ducts. Applied using special equipment.

- High tack and adhesion to galvanised sheet metal
- High elasticity

400600	Falskitt AA	Gray	28 kg can
400601	Falskitt AA	Gray	280 kg barrel

Sealing Tape 182



Sealing Tape 182 is based on synthetic rubber. During application, it is easily mouldable and provides excellent adhesion to clean and dry surfaces. This sealing tape is particularly suitable for sealing flanged ventilation ducts. Can withstand diluted acids such as hydrochloric and acetic acid, thinned oxidising acids such as nitric and sulphuric acid, as well as base liquids of the sodium hydroxide type.

- Non-soluble in water
- Resistant to diluted chemicals
- Fire-resistant
- Resistant to weak acids and alkalis
- Permanently highly elastic with durable resistance to temperature and ageing
- Application temperature: +5 to +40 °C
- Working temperature: -40 to +100 °C

500120	Sealing Tape 182, Ø 9 mm x L 5 m	Black	4 x 5 m/box
--------	----------------------------------	-------	-------------



High Tack & Fix

Professional installation adhesive with rapid adhesion. Glues most construction materials.

- Fast setting
- High grip
- Weather resistant
- Negligible shrinkage
- Application temperature: +5 to +40 °C
- Working temperature: -40 to +100 °C

400410	High Tack & Fix	White	12 x 0,29 l
--------	-----------------	-------	-------------



K500 Construction Adhesive

A physically drying single-component adhesive. Adheres to most building materials, including plastic, sheet metal, wood, tile, stone and brick.

- Frost resistant
- Contact adhesive
- Fills seams
- Adheres to damp, cold and oily surfaces

400400	K500 Construction Adhesive	Yellow beige	12 x 0,3 l
--------	----------------------------	--------------	------------



Novatherm SP

Novatherm SP is a water-borne acrylate sealant for noise insulation and fire sealing. For detailed information, visit www.protega.se.

- Application temperature: from 10 °C
- Skin formation after 30 min at 23 °C
- Can be painted after 1 hour
- Cured after approx. 48 hours

400185	Novatherm SP	White	12 x 0,31 l
--------	--------------	-------	-------------



Heat Seal

Hardening fireproof sealant and filler for repairing and sealing fireplaces, stoves and chimneys.

NB: Not for use where a flexible seal is required.

- Extended temperature range up to 1200 °C.
- Colour: Black
- Hardness: Rigid (like cement plaster)
- Can be overpainted
- Pliable consistency

400569	Heat Seal	Black	12 x 0,29 l
--------	-----------	-------	-------------



Easy Fix

Easy Fix is a silicone-free lubricant that reduces friction when installing different materials such as rubber and sheet metal components.

The product provides a thin, even coating that does not evaporate, and which functions properly even at low concentrations. Easy Fix contains glycerine, film-former and wetting agent. The product is non-hazardous as defined in EC Directive 1999/45/EC.

- Silicone-free
- Solvent-free
- Long-term lubricant effect
- Concentrated jet

400191	Easy Fix	12 x 100 ml
--------	----------	-------------



PE sealing strip, self-adhesive

Self-adhesive polyethylene sealing strip designed for sheet-metal structures.

500960	PE Strip W 10 x H 6 mm x L 10 m	50 m/pack
500970	PE Strip W 15 x H 10 mm x L 5 m	25 m/pack
500975	PE Strip W 15 x H 5 mm x L 10 m	50 m/pack

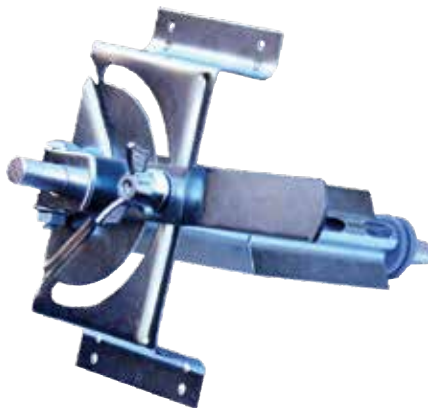

Damper regulator MD

Handle with spindle and fixing tiles to allow construction of a specific adjustable damper.

500851	Damper regulator MD	Sold individually
--------	---------------------	-------------------

CAULKING GUNS & ACCESSORIES

Caulking guns & accessories

Be sure to have the appropriate tool for the right job!

Do you only caulk once in a while? Well, then maybe a good and affordable non-drip caulking gun is what you need. On the other hand, if you have major roofing jobs, a caulking gun for 600 ml bags might be what you require.

FAQ

- **Which caulking gun is recommended for high-viscosity sealants?**
Convoy Super.
- **What does “automatic non-drip” mean?**
When the handle is released, no more sealant comes out of the tip.





Caulking gun, skeleton

Caulking gun for standard cartridges. Manual “non-drip” function.

400701

Caulking gun, skeleton

Sold individually



Caulking gun, plastic “Non-drip”

Caulking gun for standard cartridges. Automatic “non-drip” function.

400703

Caulking gun “Non-drip” Green

Sold individually



Caulking gun, Convoy RS (blue)

Convoy RS caulking gun, adjustable ratio 8:1/16:1

- ▀ Adjustable ratio
- ▀ 360° rotating body
- ▀ Dual power
- ▀ Suitable for both low- and high-viscosity sealants

400707

Caulking gun, Convoy Super (red)

Sold individually



Caulking gun, Convoy Super (red)

Caulking gun with a powerful new mechanism for extra thrust.

- Extra-powerful model with 1:26 ratio
- Ergonomic handles for comfortable grip and optimal power
- With seal puncture pin
- 360° rotating body

400708	Caulking gun, Convoy Super (red)	Sold individually
--------	----------------------------------	-------------------



Caulking gun 600

Caulking gun for 600 ml foil sausages and standard cartridges.

- High thrust ratio to cope with high-viscosity sealants (250 kg)
- Non-drip function
- Soft-grip handle
- Stainless-steel rod

400716	Caulking gun 600	Sold individually
--------	------------------	-------------------



Caulking gun 600 (yellow)

Caulking gun (steel) for 600 ml sausages.

400714	Caulking gun 600 (yellow)	Sold individually
--------	---------------------------	-------------------



Seam applicator M300/M600

Applicator that guides the seam sealant during application to the low seam. M300 fits caulking gun 400701 and 400703. M600 fits caulking gun 400714 and 400716 when using M82/Tix in 600 ml sausages.

- Reduces the risk of scratches and damage during installation as there is no need to turn the sheet
- Easy to control the width of the joint
- Fast application

400710	Seam applicator M300	Sold individually
400712	Seam applicator M600	Sold individually



Nozzles

- 400721 Universal nozzle for 600 ml sausages
- 400722 Nozzle for applicator M600
- 400725 Wide nozzle for standard cartridge
- 400726 Nozzle for standard cartridge
- 400727 Angled nozzle for standard cartridge

400721	Nozzle 163, yellow, L 140 mm	Sold individually
400722	Nozzle 063, yellow, L 120 mm	Sold individually
400725	Wide nozzle for standard cartridge	Sold individually
400726	Nozzle for standard cartridge	Sold individually
400727	Angled nozzle for standard cartridges	Sold individually

STEEL ROOF PAINT & RELATED PRODUCTS





Steel roof paint & related products

Sunchem is a leading manufacturer of steel roof paint. Most customer needs can be met quickly thanks to the production piece in Getinge. Even non standard colours are produced, according to customer specifications.

Are you unsure of what paint is appropriate for a certain kind of roof? Then take a look at the painting advice on www.sunchem.se

FAQ

- **Can you use a solvent-based topcoat on a water-based primer?**
Yes, it is fine to use Top 86 on top of Mönja Aqua, for instance.
- **I have a four-year-old, previously opened tin of Primer with small lumps in it. Can I still paint with it?**
Yes, simply stir it thoroughly and add a little white spirit if necessary.
- **Can I use your paint on pre-primed sheet metal?**
Yes. See www.sunchem.se for painting advice.
- **What tools should I use when painting with your paints?**
You can spray the paint on, or apply it with a brush or roller. The important thing is to use tools of the right quality that are designed for the purpose. Touch-up paint should, of course, be applied using a recommended touch-up brush.
- **Is the paint anti-slip?**
No, there is no specific anti-slip formula. However, the binding agent in the paint makes it safe to walk on.
- **Can I use your paint on a plastered chimney?**
No, the paint is too dense, and it will crack when moisture escapes from the plaster.



Touch-up paint/paint stick



Touch-up paint/paint stick is a special paint for touching up mechanical damage to factory-painted sheet metal, such as HBP, Green Coat, Hard Coat, polyester, plastisol, PVDF and PU. For painting advice see www.sunchem.se

- Good adhesion
- Water-based
- Fast drying

Paint stick 12 ml and Touch up can 250 ml

Art.nr. 12 ml stick	Art.nr. 250 ml can	Colour	NCS (nearest)	RAL
120006	-	Pure White (semi-matt)	S 0502-G	9003
-	150016	Pure White (matt)	S 0502-G	9003
120019	150050	Warm White (glossy)	S 0502-Y	9010
110001	130001	Antique White (glossy)	S 1002-G50Y	9002
-	150005	Antique White (semi-matt)	S 1002-G50Y	9002
120001	150001	White (semi-matt)	S 1002-Y	9002
-	150035	White (glossy)	S 1002-G	9010
-	150033	Interior White (glossy)	S 1502-Y	9002
110022	130022	Light Grey (glossy)	S 2005-G60Y	7044
120002	130030	Grey PL 60 (semi-matt)	S 2502-B	7038
-	150002	Grey (semi-matt)	S 3005-R80B	7040
110975	130975	Verdigris (glossy)	S 3020-G10Y	6021
110976	150008	Verdigris (semi-matt)	S 3020-G10Y	6021
110244	130244	Zinc Grey (glossy)	S 3502-B	7040
-	130246	Zinc Grey (semi matt)	S 3502-B	7040
110461	130461	Dove Grey (glossy)	S 3502-Y	7038
120082	-	Grey (matt)	S 4005-B20G	7000
-	150032	Burgundy (glossy)	S 4550-Y90R	3004
110985	-	Antique green (matt)	S 5020-G10Y	-
120762	140762	Russet (semi-matt)	S 5030-Y70R	8004
110742	130742	Tile Red (glossy)	S 5030-Y80R	8004
120742	140742	Tile Red (semi-matt)	S 5030-Y80R	8004
110758	130758	Red (glossy)	S 5040-Y80R	3009
120758	150007	Red (semi-matt)	S 5040-Y80R	3009
110874	130874	Leaf Green (glossy)	S 6020-G30Y	7009
110982	-	Leaf Green (semi-matt)	S 6020-G30Y	7009
110558	-	Blue (glossy)	S 6020-R90B	5009
110087	130087	Dark Grey (glossy)	S 7005-B20G	7043
120087	140087	Dark Grey (semi-matt)	S 7005-B20G	7043
-	130813	Moss Green (semi-matt)	S 7010-G30Y	6003
110978	-	Green (matt)	S 7010-G30Y	6020
120007	-	Dark Brown (semi-matt)	S 7010-Y70R	8017
120036	150036	Mountain Grey Pural (matt)	S 7502-B	7024
120088	130036	Lead Grey (glossy)	S 7502-B	7024
120090	130035	Lead Grey (semi-matt)	S 7502-B	7024
120070	130020	Graphite Grey 035 (glossy)	S 7502-B	7016
120080	130050	Titanium Grey 455 (glossy)	S 7502-B	7016

Continued overleaf

Paint stick 12 ml and Touch up can 250 ml				
Art.nr. 12 ml stick	Art.nr. 250 ml can	Colour	NCS (nearest)	RAL
120004	150022	Graphite Grey (semi-matt)	S 8000-N	7016
110830	130835	Pine Green (glossy)	S 8005-G20Y	6020
110434	130434	Chocolate Brown (glossy)	S 8005-Y80R	8017
-	140434	Chocolate Brown (semi-matt)	S 8005-Y80R	8017
120003	-	Dark Brown (semi-matt)	S 8005-Y80R	8019
110387	130387	Coffee Brown (glossy)	S 8502-Y	8019
110015	130015	Black (glossy)	S 9000-N	9011
110016	130016	Black (semi-matt)	S 9000-N	9011
120015	-	Black (matt)	S 9000-N	9011
-	130778	Metallic Copper (glossy)	-	8003
110045	130045	Metallic Silver (glossy)	-	9006
110046	-	Metallic Silver (semi-matt)	-	9006
-	130046	6045 Silver (matt)	-	9006
110044	130044	Dark Metallic Silver (glossy)	-	9007
110043	150006	Dark Metallic Silver (semi-matt)	-	9007
-	130042	Metallic Gold 42 (glossy)	-	-
120900	-	ALP Black	-	-
120905	-	ALP White	-	-
120910	-	ALP Dark Red	-	-
120915	-	ALP Tile Red	-	-
120920	-	ALP Silver	-	-
120120	130068	Durafrost Antique White 001	S 1002-G50Y	9002
120125	130070	Durafrost Light Grey 022	S 2005-G60Y	7044
120105	130062	Durafrost Cement Grey 217	S 2500-N	7038
120145	130079	Durafrost Verdigris 975	S 3020-G10Y	6021
120130	130072	Durafrost Zinc Grey 244	S 4005-R80B	7040
120165	-	Frost Tile Red 742 (matt)	S 4550-Y70R	8004
120160	-	Frost Dark Red 758 (matt)	S 5040-Y80R	3009
120155	-	Frost Dark Grey 087 (matt)	S 7005-B20G	7043
120110	130064	Durafrost Slate Grey 242	S 6502-G	7012
120115	130066	Durafrost Titanium Grey 035	S 7502-B	7016
120135	130074	Durafrost Coffee Brown 387	S 8005-Y80R	8019
120140	130076	Durafrost Brown 434	S 8010-Y70R	8017
120100	130060	Frost Black 015 (matt)	S 9000-N	9011
120150	-	Frost Silver 045 (matt)	-	9006
120153	-	Frost Dark Silver 046 (matt)	-	9007
120092	150045	Nordic Night Black RR33/SS0015 (matt)	-	-
110000	-	Empty Paint stick	-	-



Spray-up 400 ml

Spray paint intended for surface repairs to factory-painted sheet steel, roof safety- and ventilation devices.

- Contains solvents
- Invert and spray the nozzle clean after use

Spray-up 400 ml			
Art.nr	Colour	NCS (nearest)	RAL
161150	White (glossy)	S 0502-G	9003
161180	White (high gloss)	S 0502-G	9003
161190	Warm White (glossy)	S 0502-Y	9010
161195	Warm White (high gloss)	S 0502-Y	9010
161200	Antique white (glossy)	S 1002-G50Y	9002
161045	Light Grey (glossy)	S 2005-G60Y	7044
161015	Verdigris (glossy)	S 3020-G10Y	6021
161065	Zinc Grey (glossy)	S 3502-B	7040
161055	Dove Grey (glossy)	S 3502-Y	7038
161000	Tile Red (glossy)	S 5030-Y80R	8004
161010	Tile Red (semi-matt)	S 5030-Y80R	8004
161030	Dark Red (glossy)	S 5040-Y80R	3009
161040	Dark Red (semi-matt)	S 5040-Y80R	3009
161050	Dark Grey (semi-matt)	S 7005-B20G	7011
161060	Dark Grey (glossy)	S 7005-B20G	7011
161130	Graphite Grey 035 (glossy)	S 7502-B	7016
161145	Lead Grey PL18 (semi-matt)	S 7502-B	7024
161135	Graphite Grey PL 10 (semi-matt)	S 8000-N	7016
161020	Chocolate Brown (glossy)	S 8005-Y80R	8017
161025	Coffee Brown (semi-matt)	S 8502-Y	8019
161090	Black (glossy)	S 9000-N	9011
161120	Black (semi-matt)	S 9000-N	9011
161070	Silver (glossy)	-	9006
161075	Silver (semi-matt)	-	9006
161080	Dark silver (glossy)	-	9007
161085	Dark silver (semi-matt)	-	9007
161999	Nozzle for Spray-up	-	-

6-8 M²/L

Mönja Aqua

Mönja Aqua is a combined primer and anti-corrosion paint that can be used under Sunchem's other top coats. For painting advice see www.sunchem.se



- Water-based
- Prevents rust formation
- Lightly alkaline
- Contains anti-corrosive pigment
- Plasticizer stopper
- Seam primer on porous surfaces

100203	Mönja Aqua	Grey	250 ml
100204	Mönja Aqua	Grey	1 l
100205	Mönja Aqua	Grey	2,5 l
100206	Mönja Aqua	Grey	10 l

6-8 M²/L

Top 10/40 Aqua



Top 10 and Top 40 Aqua have been adapted to match today's sheet metal material. The paints feature remarkable colour stability and UV resistance. Top 10 and Top 40 Aqua provide a surface that retains its gloss and keeps off dirt - helping to prevent the formation of cracks that let in water. For painting advice see www.sunchem.se

- Top 10 is a sober semi-matt
- Top 40 is half-gloss
- High coverage - up to 8 m²
- Available in 1-, 2.5- and 10-litre packaging

CAN BE ORDERED
IN ANY NCS COLOUR

Top 10 Aqua		NCS (nearest)		
100061	Top 10 Aqua	NCS Special Colour	-	10 l
100071	Top 10 Aqua	NCS Special Colour	-	2,5 l
100081	Top 10 Aqua	NCS Special Colour	-	1 l
100060	Top 10 Aqua	RA21 Black	S 9000-N	10 l
100070	Top 10 Aqua	RA21 Black	S 9000-N	2,5 l
100080	Top 10 Aqua	RA21 Black	S 9000-N	1 l
100063	Top 10 Aqua	RA035 Slate Grey	S 7502-B	10 l
100073	Top 10 Aqua	RA035 Slate Grey	S 7502-B	2,5 l
100083	Top 10 Aqua	RA035 Slate Grey	S 7502-B	1 l
100066	Top 10 Aqua	RA742 Brick Red	S 4050-Y80R	10 l
100076	Top 10 Aqua	RA742 Brick Red	S 4050-Y80R	2,5 l
100086	Top 10 Aqua	RA742 Brick Red	S 4050-Y80R	1 l
100067	Top 10 Aqua	RA758 Dark Red	S 5040-Y80R	10 l
100077	Top 10 Aqua	RA758 Dark Red	S 5040-Y80R	2,5 l
100087	Top 10 Aqua	RA758 Dark Red	S 5040-Y80R	1 l
100062	Top 10 Aqua	RA 05 White/B-Base	-	10 l
100072	Top 10 Aqua	RA 05 White/B-Base	-	2,5 l
100082	Top 10 Aqua	RA 05 White/B-Base	-	1 l
100053	Top 10 Aqua	D-Base	-	9,5 l
100054	Top 10 Aqua	D-Base	-	2,85 l
100056	Top 10 Aqua	D-Base	-	0,95 l

6-8 M²/L

Top 40 Aqua			NCS (nearest)	
100021	Top 40 Aqua	NCS Special Colour	-	10 l
100031	Top 40 Aqua	NCS Special Colour	-	2,5 l
100041	Top 40 Aqua	NCS Special Colour	-	1 l
100020	Top 40 Aqua	RA21 Black	S 9000-N	10 l
100030	Top 40 Aqua	RA21 Black	S 9000-N	2,5 l
100040	Top 40 Aqua	RA21 Black	S 9000-N	1 l
100023	Top 40 Aqua	RA035 Slate Grey	S 7502-B	10 l
100033	Top 40 Aqua	RA035 Slate Grey	S 7502-B	2,5 l
100043	Top 40 Aqua	RA035 Slate Grey	S 7502-B	1 l
100026	Top 40 Aqua	RA742 Brick Red	S 4050-Y80R	10 l
100036	Top 40 Aqua	RA742 Brick Red	S 4050-Y80R	2,5 l
100046	Top 40 Aqua	RA742 Brick Red	S 4050-Y80R	1 l
100027	Top 40 Aqua	RA758 Dark Red	S 5040-Y80R	10 l
100037	Top 40 Aqua	RA758 Dark Red	S 5040-Y80R	2,5 l
100047	Top 40 Aqua	RA758 Dark Red	S 5040-Y80R	1 l
100022	Top 40 Aqua	RA 05 White/B-Base	-	10 l
100032	Top 40 Aqua	RA 05 White/B-Base	-	2,5 l
100042	Top 40 Aqua	RA 05 White/B-Base	-	1 l
100050	Top 40 Aqua	D-Base	-	9,5 l
100051	Top 40 Aqua	D-Base	-	2,85 l
100052	Top 40 Aqua	D-Base	-	0,95 l

4 M²/L

Flexcoat



Flexcoat is a specially developed “two in one” thick film paint for treating roof surfaces. The paint consists of a special rubber emulsion and a high-solid acrylate. Flexcoat is designed for sheet metal, galvanised sheet without chromatisation, roofing felt, Eternit, concrete roof tiles, plastisol, asphalt-treated surfaces and previously painted surfaces.

For painting advice see www.sunchem.se

- Water-based
- Sealing
- 200% elasticity
- Excellent barrier and corrosion protection
- Eco-friendly
- UV resistant
- Good adhesion

CAN BE ORDERED
IN ANY NCS COLOUR

			NCS (nearest)	
400239	Flexcoat	NCS Special Colour	-	10 l
400234	Flexcoat	RA 035 Slate Grey	S 7502-B	10 l
400235	Flexcoat	RA 975 Verdigris	S 3020-G10Y	10 l
400250	Flexcoat	RA 975 Verdigris	S 3020-G10Y	5 l
400236	Flexcoat	RA 05 White/B-base	S 0500-N	10 l
400252	Flexcoat	RA 05 White/B-base	S 0500-N	5 l
400237	Flexcoat	RA 742 Brick Red	S 4050-Y80R	10 l
400247	Flexcoat	RA 742 Brick Red	S 4050-Y80R	5 l
400238	Flexcoat	RA 030 Light Grey	S 4000-N	10 l
400248	Flexcoat	RA 030 Light Grey	S 4000-N	5 l
400240	Flexcoat	RA 21 Black	S 9000-N	10 l
400242	Flexcoat	RA 21 Black	S 9000-N	5 l
400245	Flexcoat	RA 758 Dark Red	S 5040-Y80R	10 l
400249	Flexcoat	RA 758 Dark Red	S 5040-Y80R	5 l
400246	Flexcoat	RA 434 Chocolate Brown	S 8005-Y80R	10 l
400251	Flexcoat	RA 434 Chocolate Brown	S 8005-Y80R	5 l
400255	Flexcoat	D-Base	-	9,5 l

5-6 M²/L

Grundfärg



Grundfärg is designed for priming aged galvanised steel, aluminium and zinc, as well as for use as a primer on rusty surfaces.

For painting advice see www.sunchem.se

- Contains active anti-corrosive pigment
- Provides long-term rustproofing
- Mildly corrosive
- Alkali-resistant

100201	Grundfärg	Grey	10 l
--------	-----------	------	------

5-6 M²/L

Top 86



Top 86 is an alkali-resistant roof paint that is also suitable for Eternit roofing and concrete roof tiles. For painting advice see www.sunchem.se

- Thixotropic
- Physically drying
- Solvent-based
- User-friendly at low temperatures
- Seven standard colours, NCS special colours
- Binds porous substrates

CAN BE ORDERED
IN ANY NCS COLOUR

			NCS (nearest)	
100010	Top 86	NCS Special Colour	-	10 l
100000	Top 86	RA21 Black	S 9000-N	10 l
100002	Top 86	RA758 Dark Red	S 5040-Y80R	10 l
100003	Top 86	RA742 Brick Red	S 4050-Y80R	10 l
100008	Top 86	RA035 Slate Grey	S 7502-B	10 l
100009	Top 86	RA 05 White	S 0500-N	10 l
100012	Top 86	RA434 Chocolate Brown	S 8005-Y80R	10 l
100013	Top 86	RA975 Verdigris	S 3020-G10Y	10 l

5-6 M²/L

Slät



Slät is an alkali-resistant paint for sheet metal with a higher gloss than Top 86. Smooth is also suitable for Eternit and concrete roof tiles.

For painting advice see www.sunchem.se

- Easy to apply
- Good adhesion
- Slow-ageing
- Contains UV absorbers
- For use with brush/roller only

100108	Slät	RA045 Silver (RAL 9006)	2,5 l
100114	Slät	RA044 Dark Silver (RAL 9007)	2,5 l



Condensation protection

Condensation protection (Kondensskydd) is a paint that combats condensation. It is particularly suitable for the ceilings and walls of uninsulated buildings. For painting advice see www.sunchem.se

- Durable protection against condensation
- Combats mould formation
- Contains no harmful solvents
- Fire-resistant
- Noise-absorbing
- Absorbs 250–500 ml water/m²
- Approx. 1 kg per 2.4 m²

640019	Condensation protection	Grey White	2,9 kg/can
640020	Condensation protection	Grey White	13 kg/can



Tvätt

Wash (Tvätt) is an alkaline cleaning agent used to treat metal roofs before painting. It is based on an ammonia solution with environmentally approved surfactants that dissolve dirt and grease from the roof plate.

- Coverage: approx. 1 l/10 m²
- Dilute 1 part concentrate in 7 parts water

100250	Tvätt 25 l premixed	25 l
100252	Tvätt 5 l concentrated	5 l



Bostik Adhesive Cleaner

Adhesive remover and brush cleaner. Expands on contact and effectively removes residues of water-based and solvent-based adhesives. Will not harm painted surfaces.

400561	Bostik Adhesive Cleaner	0,5 l
--------	-------------------------	-------



Etching detergent

Disinfectant wash (Betningstvätt) consisting of dilute phosphoric acid, for artificially ageing newly laid galvanised sheet.

- Coverage: approx. 1 l/10 m²

100253	Etching detergent	5 l
100254	Etching detergent	1 l



Thinner NT001 / Förtunning 44

Thinner (Förtunning 44) is intended for diluting oil-based and alkyd paints and for cleaning tools.

100300	Thinner NT001 / Förtunning 44	5 l
--------	-------------------------------	-----



White Spirit

White spirit (Lacknafta) for diluting oil-based and alkyd paints, for cleaning brushes and for removing stains.

100350	White spirit	12 x 1 l
100351	White spirit	5 l

PAINTING TOOLS





Painting tools

A good and long-term outcome requires proper tools. The right brush is especially important for beginners and those who only paint occasionally.

In this section you will find what brushes are suitable for touch-up painting, lap painting and painting with water-based paints, among many other things.

FAQ

- **Are your brushes dropping bristles?**
Ordinary brushes can drop bristles. For the best result, use the brushes ABRA recommends.
- **Why does the paint flow badly during application?**
It is important to have the right brush for the paint you are using. Another reason could be that the ambient temperature is too high.
- **What is the difference between painting with a roller and with a brush?**
It is easier to use a roller, but when painting angles and corners a brush is preferable. It is usually easier to apply the correct paint thickness with a good brush. When using a roller, it is important not to spread the paint too much, or the paint layer will be too thin.
- **Why should the paint be applied several times?**
It is important in order to achieve the right thickness of paint and to ensure a weatherproof and durable outcome.
- **Why doesn't the touch-up paint match the colour on the steel sheet?**
The paint was probably not stirred sufficiently. It can take up to two minutes of stirring to bring the pigment out. However, it is never possible to achieve an absolutely perfect match for factory-painted sheet steel.



Touch-up brush

Brush for touching up minor scratches and damage.

200250	Touch-up brush	Sold individually
--------	----------------	-------------------



Touch-up brush 25/50 mm

Brush for touch-up painting and painting small areas where a high-quality surface is required.

- Bristles for smooth paint flow
- Especially suitable for water-based paint

200255	Touch-up brush 25 mm	Sold individually
200260	Touch-up brush 50 mm	Sold individually



Sponge brushes

Sponge brushes for touch-up painting.

- Ensures a fine paint application

200262	Sponge brush, 25 mm	Sold individually
200264	Sponge brush, 50 mm	Sold individually

Angle brush 70 mm, aqua



High-quality angle brush for water-based paint. The brush features fine bristles and an easy-grip wooden handle.

- Bristles for smooth paint flow
- Carries a lot of paint in the bristles
- Suitable for thick paint

200105	Angle brush 70 mm, aqua	Sold individually
--------	-------------------------	-------------------

Sheet-metal brush, round



Sheet-metal brush for painting seams, angles and corners. Rigid mixed bristles for solvent-based paints, but also works suitable for Flexcoat.

- Carries a lot of paint in the bristles
- Durable
- Fits extension rod 200650

200010	Sheet-metal brush, round	Fits extension rod 200650	Sold individually
--------	--------------------------	---------------------------	-------------------

Synthetic pro brush



Robust brush with fully synthetic bristles of the highest quality, for water-based paint. Excellent for painting façades and roofs..

- Bristles for smooth paint flow
- Carries a lot of paint in the bristles
- Fits extension rod 200650 and 200651
- Durable

200114	Synthetic pro brush with click 120x35mm (soft)	Fits extension rod 200650 and 200651	Sold individually
--------	------------------------------------------------	--------------------------------------	-------------------

Solido pro brush

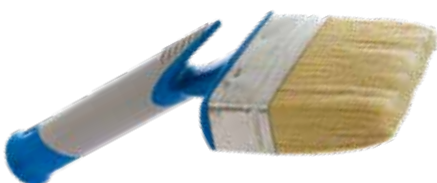

Robust brush with hard mixed bristles, for solvent-based paint. Also suitable for Flexcoat.

- Carries a lot of paint in the bristles
- Durable
- Fits extension rod 200650 and 200651

200112	Solido pro brush with click 120x35mm (stiff)	Fits extension rod 200650 and 200651	Sold individually
--------	----------------------------------------------	--------------------------------------	-------------------



Putty brush, blue, 30 mm

Putty brush with extra-stiff bristles for applying sealant.

200270	Putty brush, blue, 30 mm	10 pcs
--------	--------------------------	--------



Radiator brushes premium

Premium radiator brushes intended for painting, caulking, washing and oiling.

200230	Radiator brush premium 25 mm	12 pcs
200231	Radiator brush premium 35 mm	12 pcs
200232	Radiator brush premium 50 mm	12 pcs



Radiator brushes

Simple brushes for caulking, washing, oiling etc.

200203	Radiator brush 25 mm	12 pcs
200200	Radiator brush 35 mm	12 pcs
200201	Radiator brush 50 mm	12 pcs
200202	Radiator brush 70 mm	12 pcs



Acid brush 15

Simple flat brush for acid and grease.

200300	Acid brush 15	12 pcs
--------	---------------	--------



Stick roller frame, mini

Roller frame with stick system that allows the replacement of a used roller without having to touch it

- Fits extension rod 200650 and 200651

200420	Stick roller frame M L 560 mm	Fits extension rod 200650 and 200651	Sold individually
--------	-------------------------------	--------------------------------------	-------------------



Mini stick rollers

Stick roller with stick system that allows the replacement of a used roller without having to touch it. Fits stick roller frame 200420.

- For water-based and solvent-based paints
- Carries a lot of paint
- Suitable for thick paint

200422	Stick roller M L 150 mm Ø 35 mm	Sold individually
200424	Stick roller M L 120 mm Ø 52 mm	Sold individually



Micro-felt roller, mini

Micro-felt roller 250 mm. Micro-felt roller with stick system that makes it possible to replace a used roller without having to handle it. Fits stick roller frame 200420.

- For water-based and solvent-based paints
- For a smooth finish

200423	Micro-felt roller, mini Ø 25 mm	Sold individually
--------	---------------------------------	-------------------



Roller frame 250

Roller frame with stick system that allows the replacement of a used roller without having to touch it.

- Fits extension rod 200650 and 200651

200426	Stick roller frame 250 mm	Fits extension rod 200650 and 200651	Sold individually
--------	---------------------------	--------------------------------------	-------------------



Stick roller 250

Stick roller with stick system that allows the replacement of a used roller without having to touch it. Fits stick roller frame 200426.

- For water-based and solvent-based paints
- Carries a lot of paint
- Suitable for thick paint

200428	Stick roller 250 mm		Sold individually
--------	---------------------	--	-------------------



Micro-felt roller 250 mm

Micro-felt roller with stick system that makes it possible to replace a used roller without having to handle it. Fits stick roller frame 200426.

- For water-based and solvent-based paints
- For a smooth finish

200429	Micro-felt roller 250 mm		Sold individually
--------	--------------------------	--	-------------------

Corner roller



Corner roller for painting seams and corners, with replaceable roller.

- For water-based and solvent-based paints
- Carries a lot of paint
- Suitable for thick paint
- Fits extension rod 200650 and 200651

200502	Corner roller	Fits extension rod 200650 and 200651	Sold individually
--------	---------------	--------------------------------------	-------------------

Replacement roller for corner roller



200503	Replacement roller for corner roller		Sold individually
--------	--------------------------------------	--	-------------------

Extension rod



Telescopic extension rod.

- 120-240 cm
- Reinforced aluminium construction

200650	Extension rod 120 - 240 cm		Sold individually
--------	----------------------------	--	-------------------

Extension rod with click



Glass fibre extension rod with click. Extendable from 95 to 160 cm.

- 95 - 160 cm
- Fits our range of brushes/rollers

200651	Extension rod with click 95 - 160 cm		Sold individually
--------	--------------------------------------	--	-------------------



Paint container for sloping roofs

Paint can with slanted base designed for sloping roofs. Seam attachment holds the container on the seam.

- Holds 10 litres

300550	Paint container for sloping roofs	Sold individually
--------	-----------------------------------	-------------------



Rubber Squeegee, double blade

Rubber Squeegee, double blade. Sturdy, double-bladed rubber squeegee in stainless steel with a water edge. For applying varnish, primer, paint, hard wax oil, or for ordinary water removal and cleaning.

300100	Rubber Squeegee, double blade with edge, 45 cm, including 150 cm wooden rod	Sold individually
--------	-----------------------------------------------------------------------------	-------------------



Sanding block

Sanding block for roughening shiny surfaces to be painted. Fits sanding block holder 200710.

200700	Sanding block	Sold individually
--------	---------------	-------------------



Sanding Block Holder

Holder including wooden handle for sanding block 200700.

200710	Sanding Block Holder	Sold individually
--------	----------------------	-------------------



Wire brush

Wire brush, six-row, with scraper.

300300	Wire brush, six-row, with scraper	Sold individually
--------	-----------------------------------	-------------------



Long scraper 1200

Long scraper with replaceable blade.

300350	Long scraper 1200 mm	Sold individually
300351	Blade for long scraper	Sold individually



Putty knife 60

Putty knife for filling sealants etc.

300450	Putty knife 60 mm	Sold individually
--------	-------------------	-------------------

DUCT PROFILE SYSTEMS





Duct profile systems

Sunchem AB manufactures and sells the market-leading duct profile systems Duct-profile 99, ABRA Duct-profile and EURO Duct-profile.

Production takes place in Partille near Gothenburg, which means that many items are kept in stock at Sunchem's central warehouse.

FAQ

- **Is the stainless-steel duct acid-proof?**
Yes.
- **Can you cut the stainless-steel duct with a cutting tool?**
No, we advise against this since it risks damaging the tool.
- **Does the sealant dry in the duct strips?**
No, a joint of non-drying "Falskitt AA" seam sealant remains in the Duct-profile.
- **Can you use C-profile 99 with the ABRA Duct-profile?**
No, you should use C-profile 99 with Duct-profile 99 and ABRA Guide with ABRA Duct-profile.
- **Is the aluzinc duct of AZ-185 quality?**
Yes.
- **Are the zinc-magnesium Duct-profile and C-profile of ZM 310 quality?**
Yes.

ONE SYSTEM OF QUALITY

ABRA SYSTEM DUCT-PROFILE

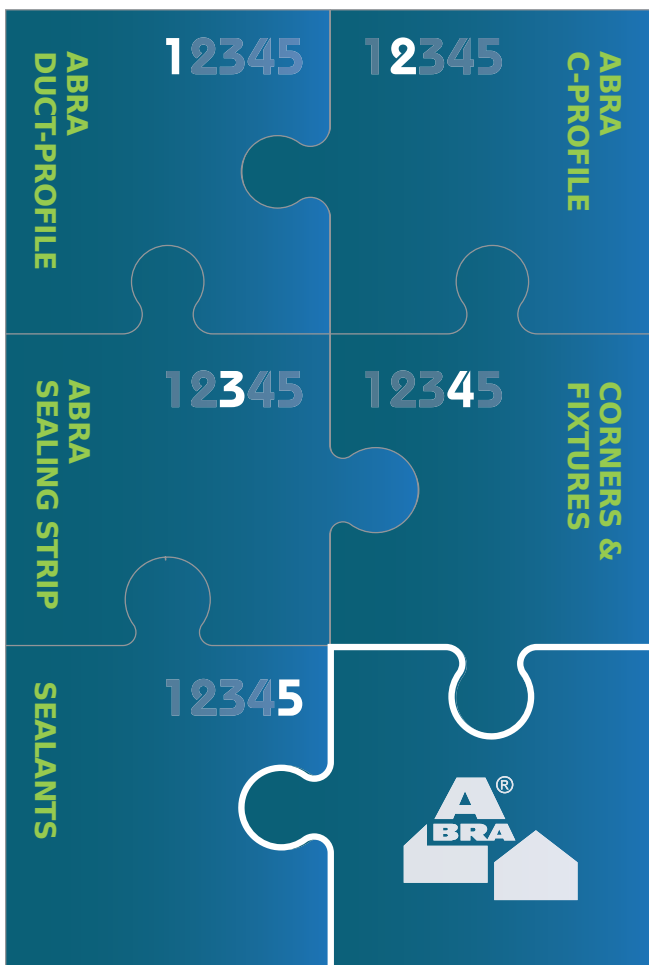

ABRA SYSTEM DUCT-PROFILE

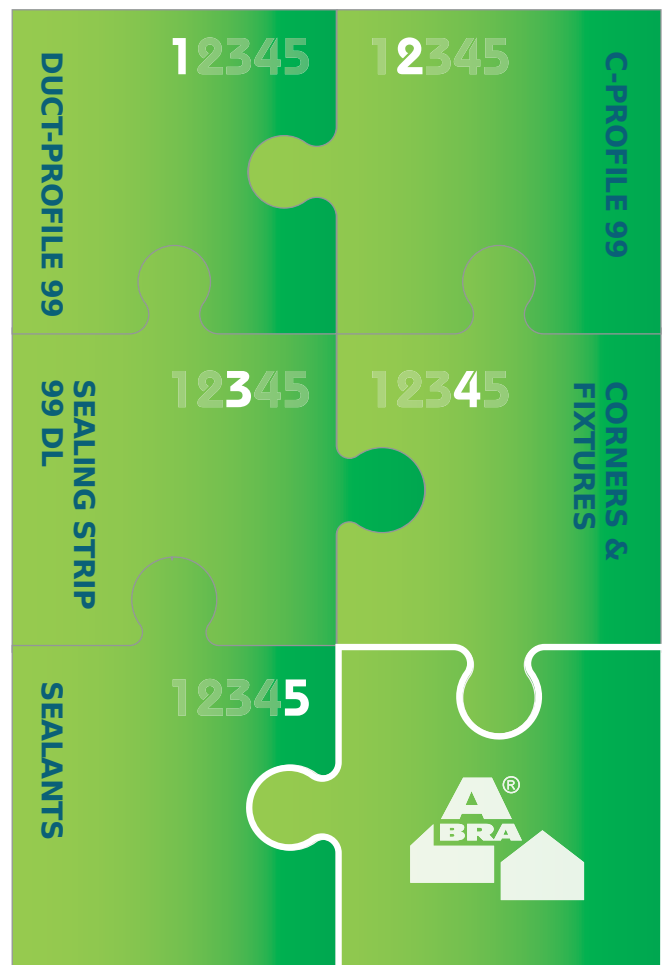

Five pieces of the puzzle = one system of quality

ABRA Duct-profile

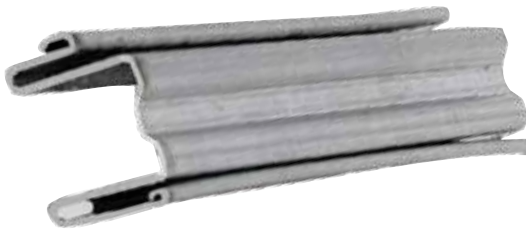

ABRA Duct-profile for the construction of square ventilation ducts.

- Torsionally rigid construction
- Sealing strip of resilient polyethylene
- Can be cut straight when safety corners used
- Contains non-drying Seam Sealant AA

500000	Galvanised – length 5 m ABRA Duct-profile	15 x 100 m/pack
500003	Galvanised – length 2.5 m ABRA Duct-profile	15 x 100 m/pack
500001	Aluzinc (185) – length 5 m ABRA Duct-profile	100 m/pack
500002	Stainless (1.4404) – length 5 m ABRA Duct-profile	5 m/piece
500004	Zinc Magnesium (310) – length 5 m ABRA Duct-profile	5 m/piece

ABRA C-profile



ABRA C-profile for joining ventilation ducts with ABRA Duct-profile.

- Cut lengths (on request)

500051	Galvanised – length 2.5 m ABRA C-profile	10 x 100 m/pack
500052	Aluzinc (185) – length 2.5 m ABRA C-profile	100 m/pack
500053	Stainless (1.4404) – length 2.5 m ABRA C-profile	2.5 m/piece
500054	Zinc Magnesium (310) – length 2.5 m ABRA C-profile	2.5 m/piece

ABRA sealing strip



Sealing strip for fitting in ABRA Duct-profile.

- Resilient polyethylene
- Temperature resistant: -50 to +90 °C

500101	Sealing strip “roll” blue, W 14 mm x H 17 mm x L 10 m	500 m/pack
--------	-------------------------------------------------------	------------



ABRA Safety Corner



Bracing corners for fitting in ABRA Duct-profile to strengthen duct.

- Fixes sealing strip when cutting straight

500160	Galvanised - ABRA Safety Corner (80 x 80 mm)	600 pcs/can
500167	Zinc Magnesium (310) Abra Safety Corner (80 x 80 mm)	600 pcs/can



ABRA Bracing Corner, small



Bracing corner 60 x 60 mm for fitting on the reverse side of an ABRA Duct-profile.

500200	Galvanised - ABRA Bracing Corner (60 x 60 mm), small	400 pcs/can
500203	Galvanised - ABRA Bracing Corner, small	10,000 units/pallet



ABRA Bracing Corner, large



Bracing corner 150 x 150 mm for fitting on the outside of the duct.

500201	Galvanised - ABRA Bracing Corner, large (150 x 150 mm)	100 pcs/can
500207	Zinc Magnesium (310) Abra Bracing Corner, large (150 x 150 mm)	100 pcs/can



Duct-profile 99



Duct-profile for the constructing square ventilation ducts.

- L-shaped sealing strip (500081)
- Can be cut straight when Inside Corner 99 used
- Cut lengths (on request)
- Contains non-drying Seam Sealant AA

500060	Galvanised - length 5 m Duct-profile 99	30 x 50 m/pack
500061	Galvanised - length 3 m Duct-profile 99	1000 x 3 m/pallet
500067	Galvanised - cut lengths Duct-profile 99	Full pallet
500066	Aluzinc (185) - length 5 m Duct-profile 99	100 m/pack
500068	Aluzinc (185) - cut lengths Duct-profile 99	Full pallet
500064	Zinc Magnesium (310) - length 5 m Duct-profile 99	5 m/piece
500065	Stainless (1.4404) - length 5 m Duct-profile 99	5 m/piece



C-profile 99



C-profile 99 for joining ventilation ducts with Duct-profile 99.

- Cut lengths (on request)

500070	Galvanised - length 5 m C-profile 99	5 x 200 m/pack
500071	Galvanised - length 2.5 m C-profile 99	10 x 100 m/pack
500072	Galvanised - length 3 m C-profile 99	1334 x 3 m/pallet
500077	Galvanised - cut lengths C-profile 99	Full pallet
500076	Aluzinc (185) - length 2.5 m C-profile 99	100 m/pack
500078	Aluzinc (185) - cut lengths C-profile 99	Full pallet
500074	Zinc Magnesium (310) - length 2.5 m C-profile 99	2.5 m/piece
500075	Stainless (1.4404) - length 2.5 m C-profile 99	2.5 m/piece



Sealing Strip 99

Rectangular sealing strip for fitting in Duct-profile 99.

- Resilient
- Temperature resistant: -70 to +100 °C

500080	Sealing Strip 99 (black) W 8 mm x H 15 mm x L 10 m	900 m/box
--------	----------------------------------------------------	-----------



Sealing Strip 99 DL (L profile)

L-shaped sealing strip for fitting in Splice 99.

- Large fitting tolerances
- Temperature resistant: -40 to +90 °C



500081	Sealing Strip 99 DL profile (grey) W 19 mm x H 13 mm x L 100 m	100 m/box
--------	----------------------------------------------------------------	-----------



Inside Corner 99

Inside Corner 99, bracing corner for assembling Duct-profile 99.



500140	Galvanised Inside Corner 99	1500 pcs/can
500145	Stainless (1.4404 2B) Inside Corner 99	100 pcs/pack
500146	Aluzinc (185) Inside Corner 99	1500 pcs/can
500147	Zinc Magnesium (310) Inside Corner 99	1500 pcs/can



Outside corner, multipurpose

Outside corner (corner protection) for fitting over C-profile corners.

- Clip fixing for quick fitting
- Screw holes



500251	Outside Corner, multipurpose with fitting holes	500 pcs/can
500252	Stainless (1.4404) Outside Corner, multipurpose with fitting holes	Sold individually
500257	Zinc Magnesium (310) Outside Corner, multipurpose with fitting holes	500 pcs/can



Outside corner, multipurpose, plastic

Outer corner (corner protection) for fitting over the C-profile.

- Clip fixing for quick fitting
- Fits stainless systems

500625	Outside corner, multipurpose, plastic	Sold individually
--------	---------------------------------------	-------------------



Inner support fixture



For inside support of square ventilation ducts.

500180	Galvanised - Inner support fixture 150 mm	600 pcs/pallet
500184	Zinc Magnesium (310) - Inner support fixture 150 mm	115 pcs/can
500185	Stainless (1.4404) - Inner support fixture 150 mm	Sold individually
500186	Aluzinc (185) - Inner support fixture 150 mm	115 pcs/can



HP Corner



For fitting in hat profiles.

500170	Galvanised - ABRA HP-Corner	100 pcs/pack
500172	Aluzinc (185) - ABRA HP-Corner	100 pcs/pack

Fitting bracket

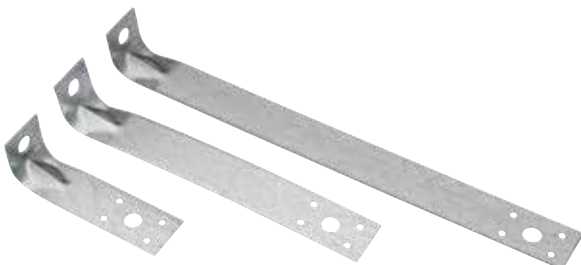

Universal suspension bracket for fitting ducts.

500260	Fitting bracket 100 mm	100 pcs/box
500262	Fitting bracket 200 mm	100 pcs/box
500264	Fitting bracket 300 mm	100 pcs/box

Drain cup

For draining condensation/rinsing water.



500750	Drain cup 3/4" internal thread with lock nut	15 pcs/box
500751	Drain cup 2" internal thread with lock nut	Sold individually
500754	Drain cup 3/4" stainless steel internal thread with lock nut	Sold individually

EUROSYSTEM

EURO Duct-profile

Duct-profile for constructing square ventilation ducts.



500600	EURO Duct-profile -20, 5 m long (FZ150) with hot melt	1000 m/pack
500880	EURO Duct-profile -30, 5 m long (FZ150) with hot melt	1000 m/pack
500881	Euro Duct-profile -20, 5 m long (FZ275) with hot melt	1000 m/pack
500602	EURO Duct-profile -20, 5 m long, Stainless AISI 304	5 m/pcs
500882	EURO Duct-profile -30, 5 m long, Stainless AISI 304	5 m/pcs

EURO C-profile

EURO C-profile for joining ventilation ducts with EURO Duct-profile.



500605	EURO C-profile -20, 5 m (FZ150)	1000 m/pack
500606	EURO C-profile -20, 5 m long, Stainless AISI 304	5 m/pcs



EURO Sealing Strip

Self-adhesive sealing strip for fitting to EURO Duct-profile.

500620	EURO Sealing Strip W 20/-30 mm x H 15 mm x L 10 m	200 m/box
--------	---------------------------------------------------	-----------



EURO Corner

Bracing corner for fitting in EURO Duct-profile.

500610	EURO Corner -20	500 pcs/can
500875	EURO Corner -30	250 pcs/can
500611	EURO Corner -20, Stainless AISI 304	Sold individually
500876	EURO Corner -30, Stainless AISI 304	Sold individually



EURO Clamp 20-40 mm

Clamp for assembling EURO Duct-profile.
Fits 20–40 mm duct profiles.

500615	EURO Clamp 20-40	400 pcs/can
--------	------------------	-------------

TOOLS & ACCESSORIES FOR DUCT PROFILE SYSTEMS





Tools & Accessories for duct profile systems

Sunchem is marketing tools for producers, assemblers and installers of rectangular ventilation ducts.

In the following section you can read about everything from pruners to duct tighteners and hydraulic clamping pliers used for assembling duct profiles for ventilation ducts. When it comes to hydraulic clamping pliers Sunchem has its own line called Gold, which was developed for customers who demand extra-high performance. Naturally, Sunchem cater for the service of all hydraulic clamping pliers in stock.

FAQ

- **What is the advantages of the “Gold” hydraulic clamping pliers?**

It is stronger, faster and has better gaskets, thus reducing the need for service. Gold is recommended for installers who use clamping pliers frequently.

- **Does Sunchem AB repair and service pliers?**

Yes, although in some cases it is not cost-effective to do so. If you send them to us we will decide the best course of action.

- **Is it possible to just replace the upper part of the mitre tool?**

Mostly, this works fine, but you cannot be 100% certain without testing it. Old models always require adjustment.



Hydraulic clamping pliers KV 3

Hydraulic clamping pliers for fitting duct profiles on ventilation ducts. The Gold series model has stronger gaskets and an oil reservoir, and is a stronger and faster machine.

- Used from inside the duct
- Primarily intended for the ABRA Duct-profile

500450	Locking pliers KV3-D327	Sold individually
500455	Locking pliers "GOLD" KV3-D325G	Sold individually
500451	Pin for KV3	Sold individually
500469	Oil for locking pliers	Sold individually

Spare parts for locking pliers are available to order.



Hydraulic clamping pliers KV 4

Pliers for fitting duct profiles on ventilation ducts. The Gold series model has stronger gaskets and an oil reservoir, and is a stronger and faster machine.

- Used from outside the duct.
- Works with both splicing systems, usually for Duct-profile 99

500460	Locking pliers KV4-D327	Sold individually
500465	Locking pliers "GOLD" KV4-D325G	Sold individually
500461	Pin for KV4	Sold individually
500469	Oil for locking pliers	Sold individually

Spare parts for locking pliers are available to order.



Clamping pliers 98, manual

Manual mounting for fitting duct profiles on ventilation ducts.

- Length 28 cm

500510	Clamping pliers 98 (manual) Duct profile 99/Abra duct profile	Sold individually
500515	Pin for Clamping pliers 98	Sold individually



Lock hammer

Pneumatic lock hammer for closing Pittsburgh locks. Supplied complete with mandrel and support sleeve. Suitable working pressure 6-7 bar.

500466	Lock hammer	Sold individually
500468	Spring RRN 11P 3520 0344 Soft	Sold individually



C-profile tool with SDS + attachment

C-profile tool for mounting of c-profiles. Suitable for all types of impact hammers with SDS + attachment.

500530	C-profile tool with SDS + attachment	Sold individually
--------	--------------------------------------	-------------------



Duct tightener

For joining ventilation ducts when c-profiles are to be installed. The discs can be reversed.

500535	Duct tightener	Sold individually
--------	----------------	-------------------



Cutting machine 2005/2, hydraulic

Cutting machine for cutting Duct-profile 99 alternatively the ABRA Duct-profile

- Including hardened mitre tool
- For galvanised, aluzinc and zinc magnesium
- Standard 220 V
- Cutting capacity: up to 15 units/minute
- Accessories: cutting tool for c-profiles and hat profiles.

500300	Hydraulic cutting machine 2005/2 for ABRA Duct/Duct 99 incl. mitre tool	Sold individually
--------	-------------------------------------------------------------------------	-------------------



ABRA Mitre tool

Tool for mitring/cutting ABRA Duct-profile. Fits cutting machine 500300.

- Thoroughly hardened
- For galvanised, aluzinc and zinc magnesium

500410	ABRA Mitre tool	Sold individually
500413	Punch for ABRA mitre tool	Sold individually



Mitre tool 99

Tool for mitring/cutting Duct-profile 99. Fits cutting machine 500300.

- Thoroughly hardened
- For galvanised, aluzinc and zinc magnesium

500415	Mitre tool 99	Sold individually
500417	Punch for mitre tool 99	Sold individually



Mitre tool 99, old model

Tool for mitring/cutting Duct-profile 99. Fits cutting machine 500330 and cutting machine 500400.

- For galvanised, aluzinc and zinc magnesium

500420	Mitre tool 99, old model	Sold individually
500422	Punch for mitre tool 99, old model	Sold individually



Sunchem AB

Box 69, S-433 21 Partille.
Telefon +46 31 447310.
infomail@sunco.se